

FCS-FB-B30

SMA Connector, DC~26.5GHz

Features:
* Low VSWR

Applications:
* Wireless
* Radar
* Instruments
* Electronics

Electrical

Frequency:	DC~26.5GHz
VSWR:	1.15 max.
Impedance of Dielectric:	5000MΩ min.
Impedance of Inner Conductor:	3mΩ max.
Impedance of Outer Conductor:	2mΩ max.
Voltage Withstand:	1000V DC
Impedance:	50Ω

Mechanical

RF Connector:	SMA Female
Mating Life Cycle:	500 cycles
Outer Conductor:	Gold Plated Brass
Dielectric:	PEI & PTFE
Inner Conductor:	Gold Plated Beryllium Copper

Environmental

Temperature:	-55~+165°C
--------------	------------

Outline Drawings

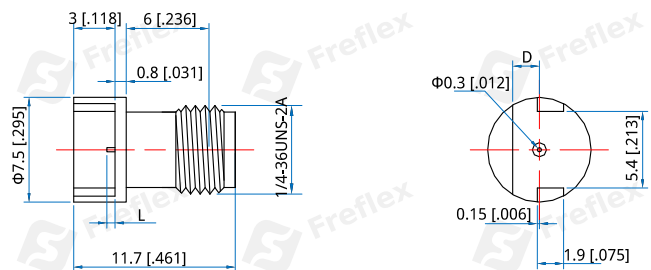

Part Number	D	L	Plate Thickness
FCS-FB-B30-01	1.93 [0.076]	0.6 [0.023]	1.78 [0.07]
FCS-FB-B30-02	0.76 [0.03]	0.6 [0.023]	0.61 [0.024]
FCS-FB-B30-03	1.02 [0.04]	0.6 [0.023]	0.87 [0.034]
FCS-FB-B30-04	2.45 [0.096]	0.6 [0.023]	2.3 [0.091]

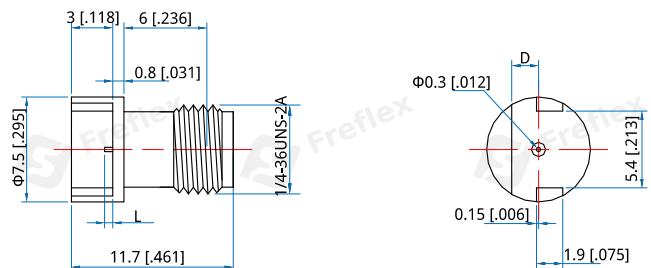

Part Number	D	L	Plate Thickness
FCS-FB-B30-05	1.93 [0.076]	1.22 [0.048]	1.78 [0.07]
FCS-FB-B30-06	0.76 [0.03]	1.22 [0.048]	0.61 [0.024]
FCS-FB-B30-07	1.02 [0.04]	1.22 [0.048]	0.87 [0.034]
FCS-FB-B30-08	2.45 [0.096]	1.22 [0.048]	2.3 [0.091]

Unit: mm [in]
Tolerance: ±0.2mm [±0.008in]