

FCS-FL2G-M

SMA Connector, DC~26.5GHz

Features:
* Low VSWR

Applications:
* Wireless
* Radar
* Instruments
* Electronics

Electrical

Frequency:	DC~26.5GHz
VSWR:	1.15 max.
Impedance of Dielectric:	5000MΩ min.
Impedance of Inner Conductor:	3mΩ max.
Impedance of Outer Conductor:	2mΩ max.
Voltage Withstand:	1000V DC
Impedance:	50Ω

Mechanical

RF Connector:	SMA Female
Mating Life Cycle:	500 cycles
Outer Conductor:	Passivated SUS303 Stainless Steel
Dielectric:	PEI & PTFE
Inner Conductor:	Gold Plated Beryllium Copper

Environmental

Temperature: -55~+165°C

Outline Drawings

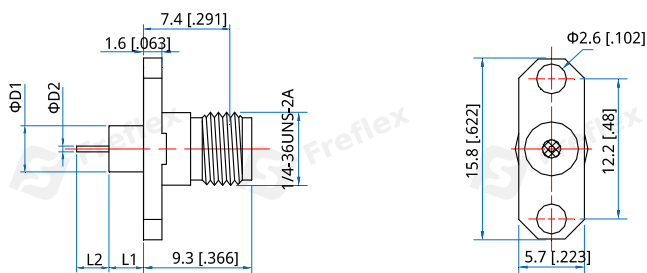

Part Number	$\Phi D1$	$\Phi D2$	L1	L2
FCS-FL2G-M80-01	4 [.158]	0.8 [.031]	4 [.158]	2 [.079]
FCS-FL2G-M38-02	4 [.158]	0.38 [.015]	3 [.118]	2 [.079]
FCS-FL2G-M38-03	4 [.158]	0.38 [.015]	3 [.118]	3 [.118]
FCS-FL2G-M38-04	4 [.158]	0.38 [.015]	3 [.118]	0.4 [.016]

Unit: mm [in]

Tolerance: $\pm 0.2\text{mm}$ [$\pm 0.008\text{in}$]

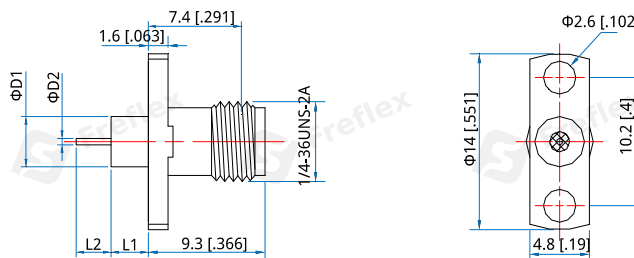

Part Number	$\Phi D1$	$\Phi D2$	L1	L2
FCS-FL2G-M80-05	4 [.158]	0.8 [.031]	4 [.158]	2 [.079]
FCS-FL2G-M38-06	4 [.158]	0.38 [.015]	3 [.118]	2 [.079]
FCS-FL2G-M38-07	4 [.158]	0.38 [.015]	3 [.118]	3 [.118]
FCS-FL2G-M38-08	4 [.158]	0.38 [.015]	3 [.118]	0.4 [.016]

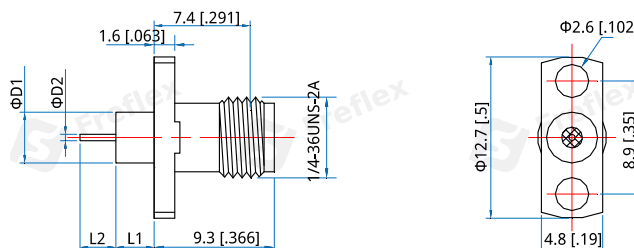

Part Number	$\Phi D1$	$\Phi D2$	L1	L2
FCS-FL2G-M80-09	4 [.158]	0.8 [.031]	4 [.158]	2 [.079]
FCS-FL2G-M38-10	4 [.158]	0.38 [.015]	3 [.118]	2 [.079]
FCS-FL2G-M38-11	4 [.158]	0.38 [.015]	3 [.118]	3 [.118]
FCS-FL2G-M38-12	4 [.158]	0.38 [.015]	3 [.118]	0.4 [.016]

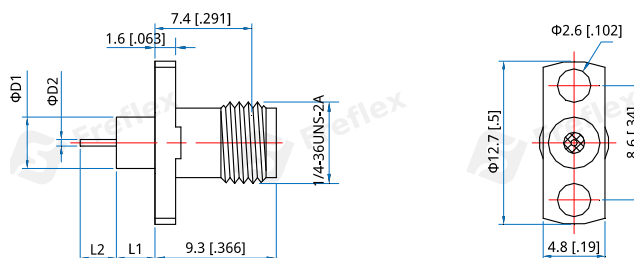

Part Number	$\Phi D1$	$\Phi D2$	L1	L2
FCS-FL2G-M80-13	4 [.158]	0.8 [.031]	4 [.158]	2 [.079]
FCS-FL2G-M38-14	4 [.158]	0.38 [.015]	3 [.118]	2 [.079]

FCS-FL2G-M38-15	4 [.158]	0.38 [.015]	3 [.118]	3 [.118]
FCS-FL2G-M38-16	4 [.158]	0.38 [.015]	3 [.118]	0.4 [.016]

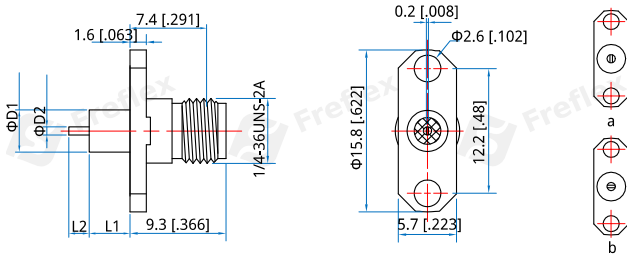

Part Number	ΦD1	ΦD2	L1	L2	
FCS-FL2G-M80-17	4 [.158]	0.8 [.031]	4 [.158]	1.5 [.059]	a
FCS-FL2G-M80-18	4 [.158]	0.8 [.031]	4 [.158]	1.5 [.059]	b

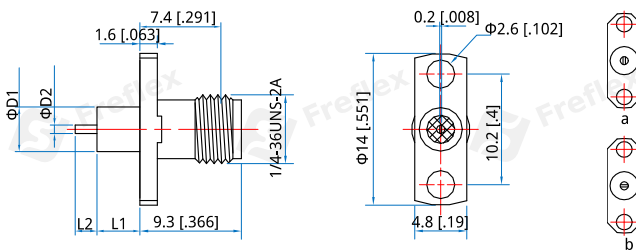

Part Number	ΦD1	ΦD2	L1	L2	
FCS-FL2G-M80-19	4 [.158]	0.8 [.031]	4 [.158]	1.5 [.059]	a
FCS-FL2G-M80-20	4 [.158]	0.8 [.031]	4 [.158]	1.5 [.059]	b

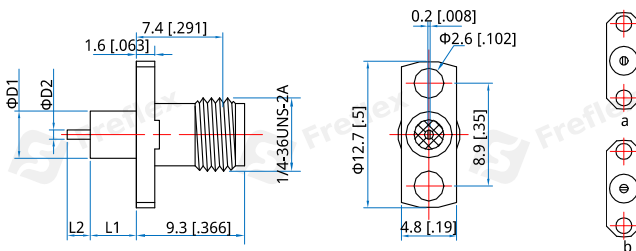

Part Number	ΦD1	ΦD2	L1	L2	
FCS-FL2G-M80-21	4 [.158]	0.8 [.031]	4 [.158]	1.5 [.059]	a
FCS-FL2G-M80-22	4 [.158]	0.8 [.031]	4 [.158]	1.5 [.059]	b

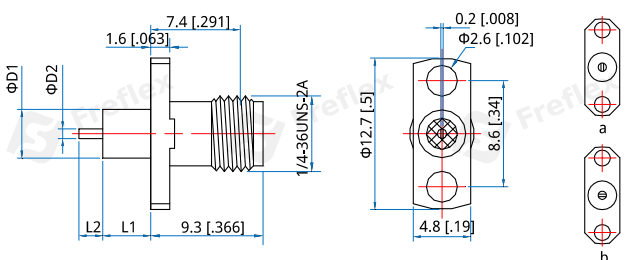

Part Number	ΦD1	ΦD2	L1	L2	
FCS-FL2G-M80-23	4 [.158]	0.8 [.031]	4 [.158]	1.5 [.059]	a
FCS-FL2G-M80-24	4 [.158]	0.8 [.031]	4 [.158]	1.5 [.059]	b