

## FDRHA-1000-20000-12.58

1~20GHz, 12.58dB

Features:  
\* Broadband

Applications:  
\* Wireless  
\* Transceiver  
\* Laboratory Test  
\* Broadcast

### Electrical

Frequency:	1~20GHz
VSWR:	2 max.
Gain:	12.58dB
H Plane Beam Width:	11.29°~60.56°
E Plane Beam Width:	13.52°~78.41°

### Mechanical

Size:	243*163.5*205.7mm 9.567*6.437*8.098in
-------	--

### Outline Drawings

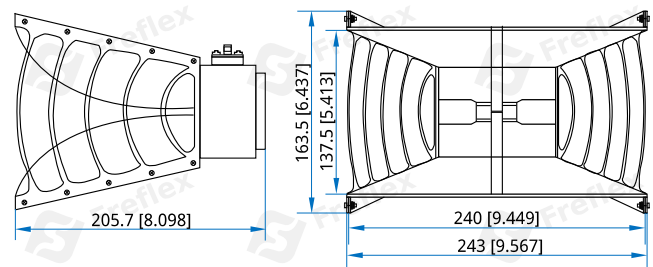

Unit: mm [in]

Tolerance:  $\pm 0.2$ mm [ $\pm 0.008$ in]

### How To Order

**FDRHA-1000-20000-12.58**

Customization is available upon request.