

FABB BNC to BNC



Features:
* Low VSWR

Applications:
* Wireless
* Transmitter
* Laboratory Test
* Radar

Specifications

Model	Frequency (GHz)	VSWR (max.)	Voltage Withstand (V)	Impedance of Dielectric (mΩ min.)	Impedance	Outer Conductor	Dielectric	Inner Conductor	Outline Drawings
FABB-MM	DC~4	1.15	1000	5000	50Ω	Ternary alloy plated brass	PTFE	Gold plated beryllium	Outline A
FABB-FF	DC~4	1.15	1000	5000	50Ω	Ternary alloy plated brass	PTFE	Gold plated beryllium	Outline B
FABB-MF	DC~4	1.15	1000	5000	50Ω	Ternary alloy plated brass	PTFE	Gold plated beryllium	Outline C
FABBB-MMM	DC~4	-	-	-	50Ω	Nickel plated brass	PTFE	Gold plated brass	-
FABBB-FFF	DC~4	-	1500	5000	50Ω	Nickel plated brass	PTFE	Gold plated brass	Outline D
FABBB-FMF	DC~4	-	1500	5000	50Ω	Nickel plated brass	PTFE	Gold plated brass	Outline E
FABBR-MF	DC~3	1.45	750	5000	50Ω	Nickel plated brass	PTFE	Gold plated beryllium	Outline F
FABBL-FF	DC~4	1.15	1000	5000	50Ω	Ternary alloy plated brass	PTFE	Gold plated beryllium	Outline G
FABBH-FF	DC~4	1.15	1000	5000	50Ω	Ternary alloy plated brass	PTFE	Gold plated beryllium	Outline H
FABB-FF-75	DC~3	1.2	-	-	75Ω	Ternary alloy plated brass	-	-	-
FABBB-FMF-75	DC~4	-	1500	5000	75Ω	Nickel plated brass	PTFE	Gold plated brass	Outline I
FABBB-FFF-75	DC~4	-	-	-	75Ω	Nickel plated brass	PTFE	-	-

Environmental

Temperature: -55~+125°C
-45~+125°C (Outline D, E)

Mechanical

RF Connectors: BNC
Mating Life Cycle: 500 cycles

Outline Drawings

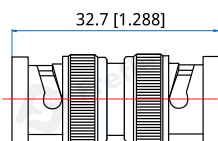

Outline A

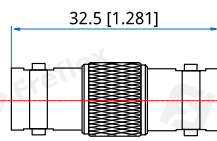

Outline B

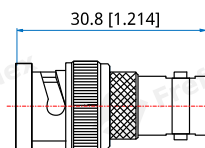

Outline C

Coaxial Adapter

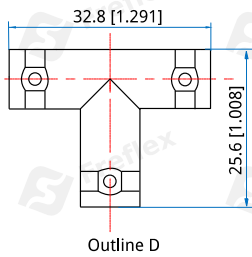

Outline D

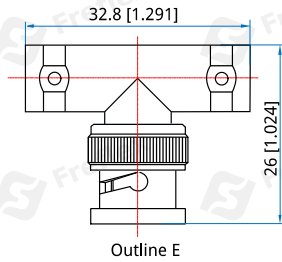

Outline E

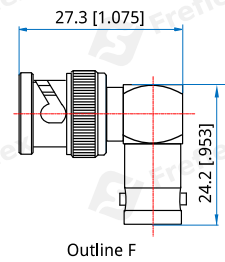

Outline F

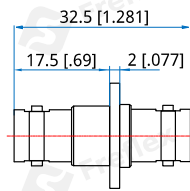

Outline G

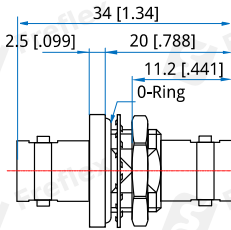
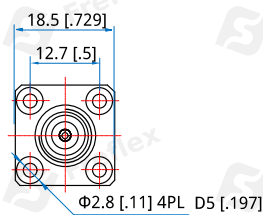

Outline H

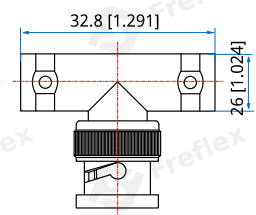
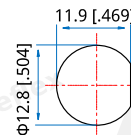

Outline I

Unit: mm [in] Tolerance: $\pm 0.2\text{mm}$ [$\pm 0.008\text{in}$]

How To Order

- FABB-MM** - BNC(m) to BNC(m), Outline A
- FABB-FF** - BNC(f) to BNC(f), Outline B
- FABB-MF** - BNC(m) to BNC(f), Outline C
- FABBB-MMM** - BNC(m) to BNC(m) to BNC(m)
- FABBB-FFF** - BNC(f) to BNC(f) to BNC(f), Outline D
- FABBB-FMF** - BNC(f) to BNC(m) to BNC(f), Outline E
- FABBR-MF** - BNC(m) to BNC(f), Right angle, Outline F
- FABBL-FF** - BNC(f) to BNC(f), Flange mount, Outline G
- FABBH-FF** - BNC(f) to BNC(f), Bulk head, Outline H
- FABB-FF-75** - BNC(f) to BNC(f), 75Ω
- FABBB-FMF-75** - BNC(f) to BNC(m) to BNC(f), 75Ω, Outline I
- FABBB-FFF-75** - BNC(f) to BNC(f) to BNC(f), 75Ω

Customization is available upon request.