

FCI-26500-40000-5-1-K-1

26.5~40GHz, 5W/1W, 2.92mm Female, Clockwise

Features:

- * Broadband
- * High Power
- * Low Insertion Loss

Applications:

- * Wireless
- * Radar
- * Laboratory Test

Electrical

Frequency:	26.5~40GHz
Insertion Loss:	1.3dB max.
Isolation:	12dB min.
VSWR:	1.7 max.
Forward Power:	5W
Reverse Power:	1W
Impedance:	50Ω

Mechanical

Size ^{*1} :	26*13*16.8mm 1.024*0.512*0.661in
RF Connectors:	2.92mm female
Mounting:	2-M2.5 through-hole
Direction:	Clockwise

[1] Exclude connectors and termination.

Environmental

Operating Temperature:	-30~+70°C
------------------------	-----------

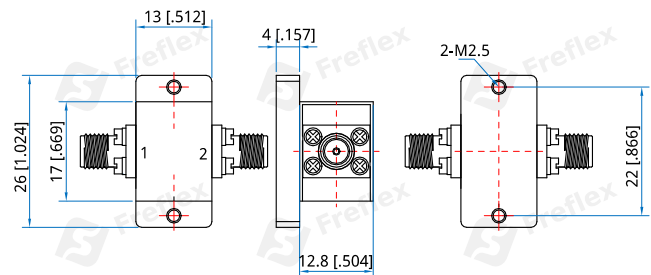
Outline Drawings

Unit: mm [in]

Tolerance: ±0.25mm [±0.01in]

How To Order

FCI-26500-40000-5-1-K-1

Customization is available upon request.