

FFTW-42

WR-42, 17.7~26.5GHz

Features:

- * Low VSWR
- * Low Insertion Loss

Applications:

- * Wireless
- * Transmitter
- * Laboratory Test
- * Instrumentation

Electrical

Frequency: 17.7~26.5GHz

Length (mm)	Insertion Loss (dB max.)	VSWR (max.)	Torsion Angle (°/m max.)	Bend Radius (mm min.)
900 (±3%)	1.08	1.2	465	38/E, 76/H
1000 (±3%)	1.3	1.3	510	38/E, 76/H
1200 (±3%)	1.45	1.25	630	30/E, 60/H

Mechanical

Waveguide Size:	WR42 (BJ220)/WG20/R220
Flange:	FBP220/FBM220
Length:	50 ≤ L ≤ 1200mm
Flange Material:	Nickel plated brass
Material of Waveguide Core:	Silver plated brass
Jacket Material:	Vulcanized silicone rubber

How To Order

FFTW-42-X-Y-Z

X: Length in mm.

Y: Material

Z: Flange type

Length in mm:

900 - 900mm (Outline B)

1000 - 1000mm (Outline A)

1200 - 1200mm (Outline A)

Material naming rules:

B - Brass (Outline A, B)

Flange naming rules:

3-3 - FBM220-FBM220 (Outline A)

1-3 - FBP220-FBM220 (Outline B)

Examples:

To order a Flexible Twistable Waveguide, WR-42, 1200mm, Brass, FBM220-FBM220, specify FFTW-42-1200-B-3-3.

Outline Drawings

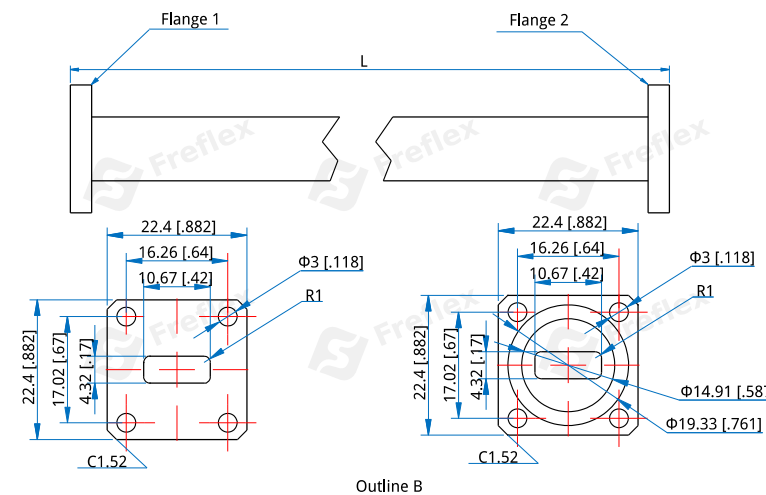
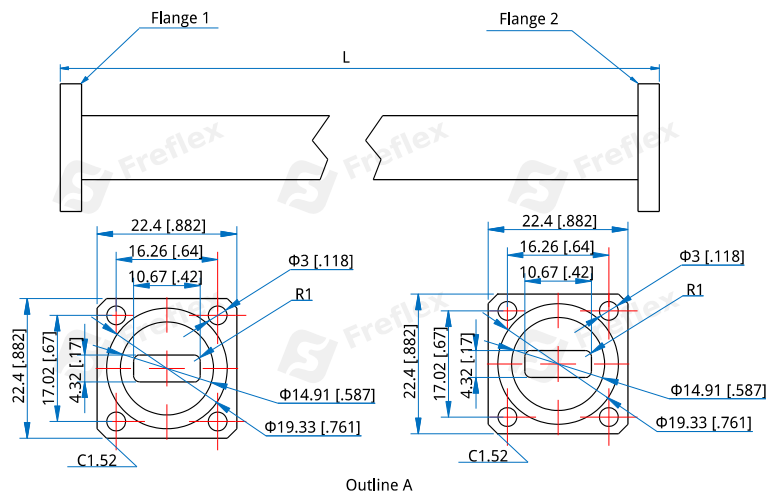

Unit: mm [in]

Tolerance: ±0.5mm [±0.02in]

Customization is available upon request.