

## FFTW-75

### WR-75, 10~15GHz

Features:  
 \* Low VSWR  
 \* Low Insertion Loss

Applications:  
 \* Wireless  
 \* Transmitter  
 \* Laboratory Test  
 \* Instrumentation

#### Electrical

Frequency: 10~15GHz

Length (mm)	Insertion Loss (dB max.)	VSWR (max.)	Torsion Angle (°/m max.)	Bend Radius (mm min.)
400 (±3%)	0.2	1.15	330	64/E, 115/H
600 (±3%)	0.3	1.15	340	64/E, 120/H
1000 (±3%)	0.5	1.10	365	54/E, 108/H

#### Mechanical

Waveguide Size:	WR75 (BJ120)/WG17/R120
Flange:	FBP120/FBM120
Length:	50 ≤ L ≤ 1200mm
Flange Material:	Nickel plated brass
Material of Waveguide Core:	Silver plated brass
Jacket Material:	Vulcanized silicone rubber

#### Outline Drawings

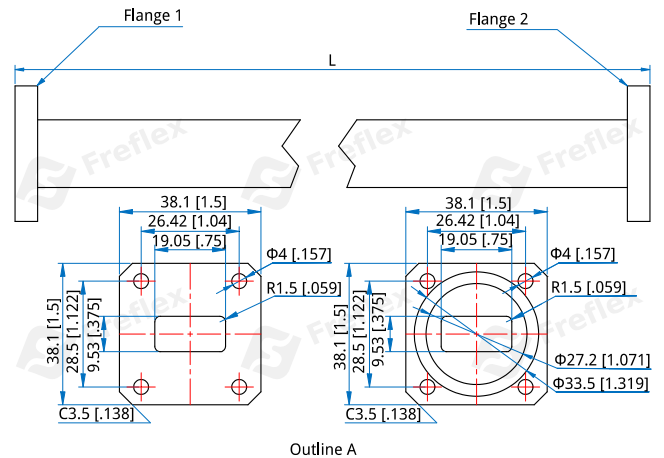

Unit: mm [in]  
 Tolerance: ±0.5mm [±0.02in]

#### How To Order

##### FFTW-75-X-Y-Z

X: Length in mm.

Y: Material

Z: Flange type

Length in mm:

400 - 400mm (Outline A)

600 - 600mm (Outline A)

1000 - 1000mm (Outline A)

Material naming rules:

B - Brass (Outline A)

Flange naming rules:

1-3 - FBP120 - FBM120 (Outline A)

Examples:

To order a Flexible Twistable Waveguide, WR-75, 600mm, Brass, FBP120 - FBM120, specify FFTW-75-600-B-1-3.

Customization is available upon request.