

FFTW90

WR-90, 8.2~12.4GHz

Features:

- * Low VSWR
- * Low Insertion Loss

Applications:

- * Wireless
- * Transmitter
- * Laboratory Test
- * Instrumentation

Electrical

Frequency: 8.2~12.4GHz

Length (mm)	Insertion Loss (dB max.)	VSWR (max.)	Torsion Angle (°/m max.)	Bend Radius (mm min.)
300 (±3%)	0.12	1.1	315	66/E, 132/H
1500 (±3%)	0.6	1.15	315	66/E, 132/H

Mechanical

Waveguide Size: WR-90 (B100)/WG16/R100
 Flange: FBP100/FBM100
 Flange Material: Nickel plated brass
 Material of Waveguide Core: Silver plated brass
 Jacket Material: Vulcanized silicone rubber

How To Order

FFTW-90-X-Y-Z

X: Length in mm.

Y: Material

Z: Flange type

Length in mm:

300 - 300mm (Outline A)

1500 - 1500mm (Outline A)

Material naming rules:

B - Brass (Outline A)

Flange naming rules:

1-3 - FBP100-FBM100 (Outline A)

Examples:

To order a Flexible Twistable Waveguide, WR-90, 1500mm, Brass, FBP100-FBM100, specify FFTW-90-1500-B-1-3.

Customization is available upon request.

Outline Drawings

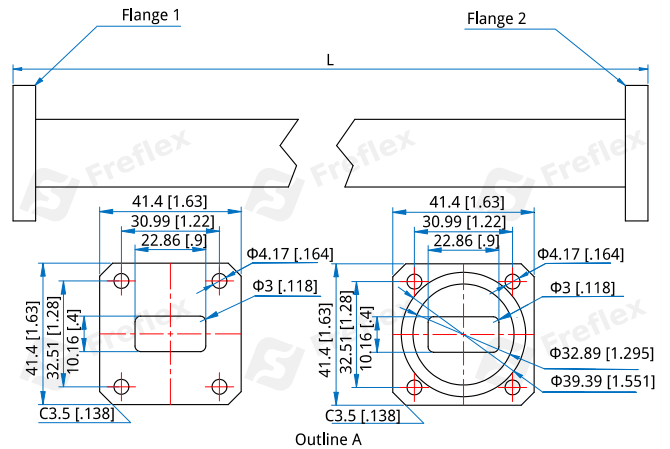

Unit: mm [in]

Tolerance: ±0.5mm [±0.02in]