

# FWT1-R5

## WR-1.0, 0.5W

Features:  
 \* Low VSWR  
 \* Broadband

Applications:  
 \* Transmitters  
 \* Antennas  
 \* Laboratory Test  
 \* Impedance Matching

### Electrical

Frequency:	750~1100GHz
Average Power	0.5W max.
VSWR:	1.3 max.

### Mechanical

Interface:	WR-1.0
------------	--------

### Environmental

Operation Temperature:	0~+40°C
No-Operation Temperature:	-40~+70°C

### How To Order

**FWT1-R5**

Customization is available upon request.

### Outline Drawings

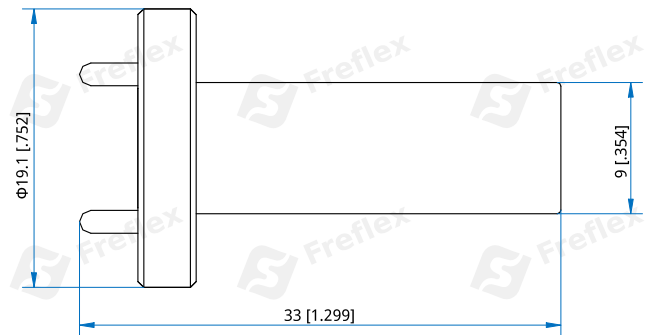

Unit: mm [in]

Tolerance:  $\pm 0.5\text{mm}$  [ $\pm 0.02\text{in}$ ]