

# FPW51

## WR-51

Features:  
\* Low VSWR

Applications:  
\* Wireless  
\* Radar  
\* Instruments  
\* Electronics

### Electrical

Frequency:	14.5~22GHz
VSWR:	1.35 max.
Insertion Loss:	0.6dB max.
Withstand Air Pressure:	0.1MPa max.

### Mechanical

Waveguide Size:	WR-51 (BJ180)
Flange:	FBP180
Material:	Copper
Finish:	Pickling passivation

### How To Order

**FPW51-X-Y**

X: Material

Y: Flange type

Material naming rules:

C - Copper (Outline A)

Flange naming rules:

1 - FBP180 (Outline A)

Examples:

To order a Pressure Window, WR-51, Copper, FBP180, specify FPW51-C-1.

Customization is available upon request.

### Outline Drawings

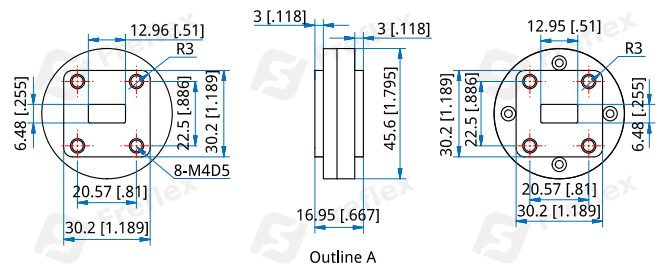

Unit: mm [in]

Tolerance:  $\pm 0.2\text{mm}$  [ $\pm 0.008\text{in}$ ]