

# FDP-50

## DC~50GHz

Features:  
 \* Durable  
 \* Low Insertion Loss  
 \* Low VSWR

Applications:  
 \* Microwave Test

### Specifications

| Frequency (GHz) | Pitch (μm) | Tip Size (μm) | IL (dB Max.) | VSWR (Max.) | Configuration | Mounting Styles | Connector    | Probe Tip Material       |
|-----------------|------------|---------------|--------------|-------------|---------------|-----------------|--------------|--------------------------|
| DC~50           | 100        | 30            | -            | -           | GSSG          | 45°             | 2.4mm female | Gold plated alloy nickel |
|                 | 125        |               | 0.75         | 1.45        |               |                 |              |                          |
|                 | 150        |               | -            | -           |               |                 |              |                          |
|                 | 190        |               | -            | -           |               |                 |              |                          |

### Electrical

Frequency: DC~50GHz  
 Recommend Overtravel: 50~75μm  
 Impedance: 50Ω

### Mechanical

Material: Aluminum Alloy

### Environmental

Operating Temperature: -45~+85°C

### Outline Drawings

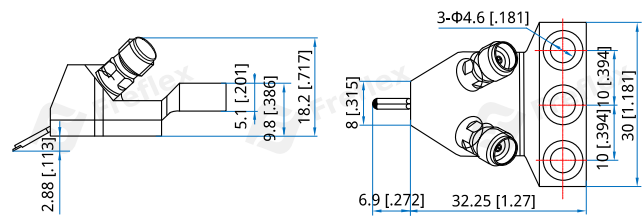

Unit: mm [inch]  
 Tolerance: ±0.25mm [±0.01in]

### How To Order

#### FDP-50-V-W-X-Y-Z-U-T

V: Configuration Type.  
 W: Pitch in μm  
 X: Tip Size in μm  
 Y: Mounting Styles. 45°: 45  
 Z: Material. Aluminum alloy: A  
 U: Probe Tip Material.  
 Gold plated alloy nickel: K

#### Examples:

To order a dual port probe, DC~50GHz, GSSG, Pitch 125μm, 30μm, 45°, Aluminum alloy, Gold plated alloy nickel, specify FDP-50-GSSG-125-30-45-A-K.

Customization is available upon request.