

FRJ1-30000-12

Single Channel, DC~30GHz, 12.5mm

Features:

- * Low VSWR
- * Low VSWR Flatness
- * Low Insertion Loss Flatness

Applications:

- * High Speed Digital Signal Transmission
- * Analog Signal Transmission

Electrical

Frequency:	DC~30GHz
VSWR:	1.35 max.@DC~8GHz 1.75 max.@DC~18GHz 2.5 max.@DC~30GHz
VSWR Flatness:	0.15 max.
Insertion Loss:	0.4dB max.@DC~8GHz 1.0dB max.@DC~18GHz 2.0dB max.@DC~30GHz
Insertion Loss Flatness:	0.15dB max.
Average Power:	20W max.@18GHz
Phase Flatness:	1.5° max.
Impedance:	50Ω

Mechanical

Connectors:	3.5mm female
Rotating Speed:	100RPM
Operation Life:	5M Cycles
IP Grade:	IP51

Environmental

Operating Temperature:	-30~+80°C
Operating Humidity:	0~85%

Outline Drawings

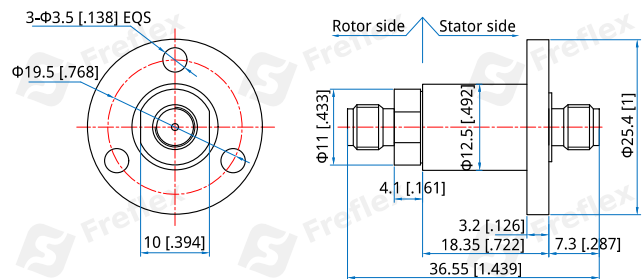

Unit: mm [in]

Tolerance: ±0.2mm [±0.008in]

How To Order

FRJ1-30000-12

Customization is available upon request.