

## FRHA15

49.8~75.8GHz, WR-15

Features:  
\* Broadband

Applications:  
\* Wireless  
\* Transceiver  
\* Laboratory Test  
\* Broadcast

### Electrical

---

Frequency: 49.8~75.8GHz  
Gain: 10, 15, 20, 25dB min.  
VSWR: 1.2 max.(Outline A, B, C, D)  
1.5 max.

### Mechanical

---

Interface: WR-15 (BJ620)  
Flange: UG385/U  
Material: Brass

### Environmental

---

Temperature: -55~+165°C

### How To Order

#### FRHA15-X-Y-Z

X: Gain in dB

10dB - Outline A, E, I

15dB - Outline B, F, J

20dB - Outline C, G, K

25dB - Outline D, H, L

Y: Connector type if applicable

Z: Installation method if applicable

Connector naming rules:

V - 1.85mm Female (Outline E, F, G, H, I, J, K, L)

Pannel Mount naming rules:

P - Pannel Mount (Outline I, J, K, L)

Examples:

To order an antenna, 49.8~75.8GHz, 15dB, WR-15, 1.85mm female, Pannel Mount, specify FRHA15-15-V-P.

Customization is available upon request.

# Standard Gain Horn Antennas

## Outline Drawings

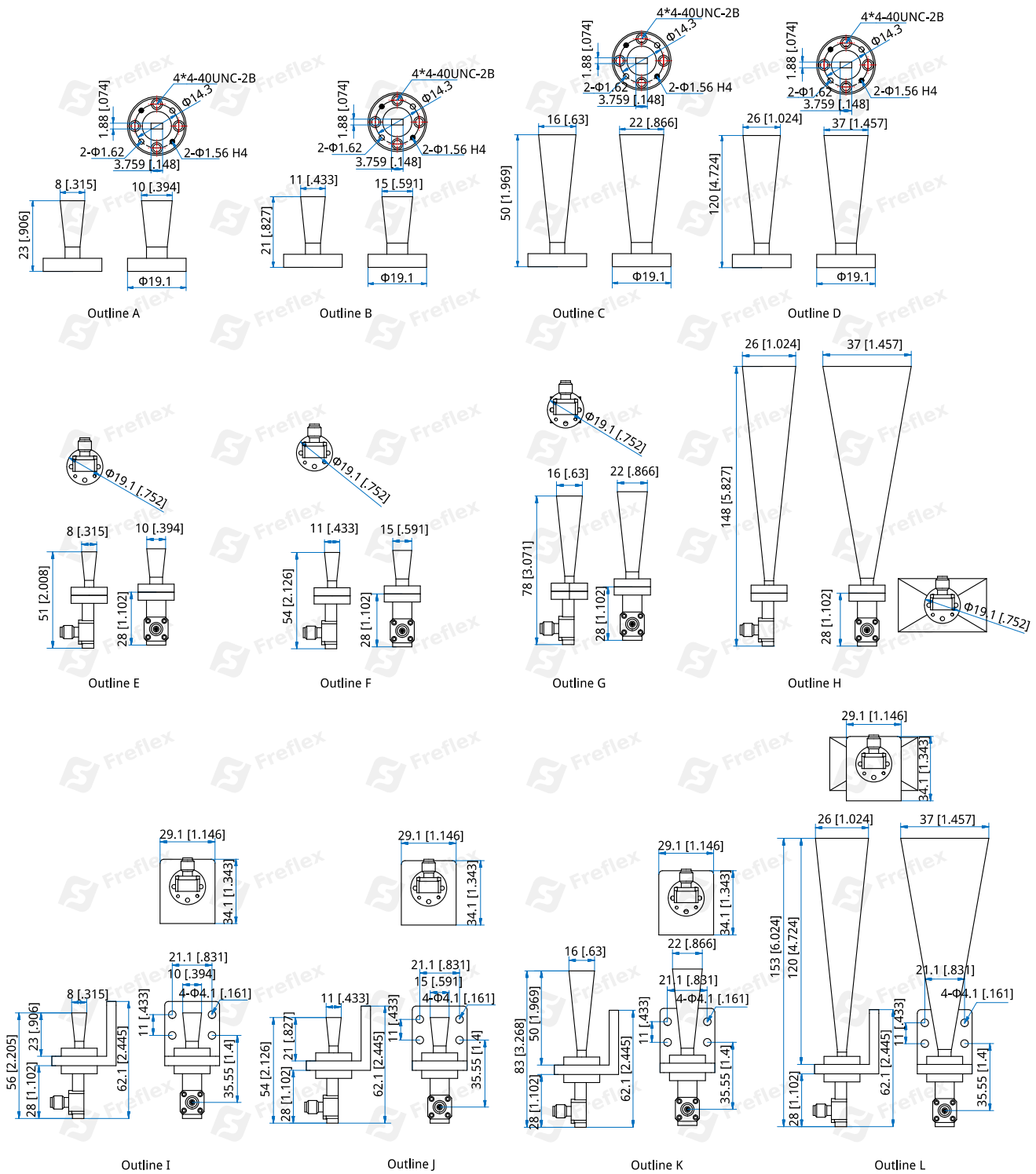

Unit: mm [in]

Tolerance:  $\pm 0.5\text{mm}$  [ $\pm 0.02\text{in}$ ]