

## FSC12R3B

### High Power, High Isolation

**Features:**

- \* High Power
- \* High Isolation
- \* Low Insertion Loss
- \* Low VSWR

**Applications:**

- \* Wireless
- \* Radar
- \* Laboratory Test

**Description**

FSC12R3B series Surface Mount Circulators cover frequency range 1400~6000MHz. High power, high isolation and low insertion loss make it ideal for a lot of applications like amplifiers, transceivers, etc.

**Specifications**

Frequency (MHz)	Bandwidth (MHz)	IL (dB Max.)	Isolation (dB Min.)	VSWR (Max.)	Average Power (W)	Temperature (°C)
2496-2696	200	0.30	23.0	1.20	60	-40 ~ +85
3250-3450	200	0.35	20.0	1.25	30	-40 ~ +85
3300-3500	200	0.35	20.0	1.25	40	-40 ~ +85
3300-3800	500	0.60	18.0	1.30	60	-40 ~ +85
3400-4000	600	0.60	17.0	1.30	60	-40 ~ +85

**Mechanical**

Size:  $\Phi 12.3 \times 7 \text{mm}$   
 $\Phi 0.484 \times 0.276 \text{in}$

**How To Order**
**FSC12R3B-W-X-Y-Z**

W: Start frequency in MHz

X: Stop frequency in MHz

Y: Average power in W

Z: Direction type

**Direction Naming Rules:**

1 - Clockwise

2 - Anticlockwise

**Examples:**

To order a FSC12R3B series Circulator, 3.3~3.8GHz, 60W, Clockwise, specify FSC12R3B-3300-3800-60-1.

Customization is available upon request.

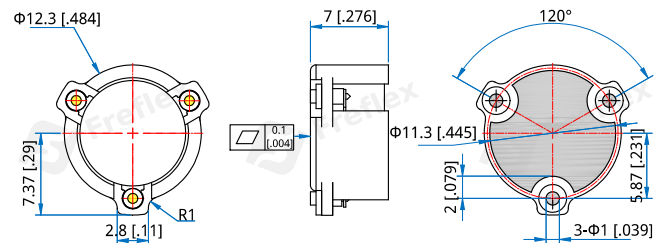
**Outline Drawings**

Unit: mm [inch]

Tolerance:  $\pm 0.2 \text{mm}$  [ $\pm 0.008 \text{in}$ ]